



Installation Instructions for Jetmaster Outback Outdoor Patio Fire



Installation Instructions for Jetmaster Outback Outdoor Patio Fire

The Jetmaster Outback Outdoor Patio Fire is heating appliance intended for use in outside areas only.

The fire consists of a decorative ceramic gas log that radiates warmth through a glass enclosure and also provides deflected convected heat through a flue terminal and termination plate on

the top of the flue. This flue is not designed to penetrate a roof or enclosure but is designed to emit heat below patio ceilings thereby providing warmth to outside area.

The firebox can be built in to an enclosure or can be freestanding. The following models are available:

Model Type 700 Insert Outdoor Patio Fire Decorative Gas Log Outdoor Heater

STEP I - UNIT AND FRAME DIMENSIONS

700 OUTDOOR PATIO FIRE UNIT AND FRAME DIMENSIONS

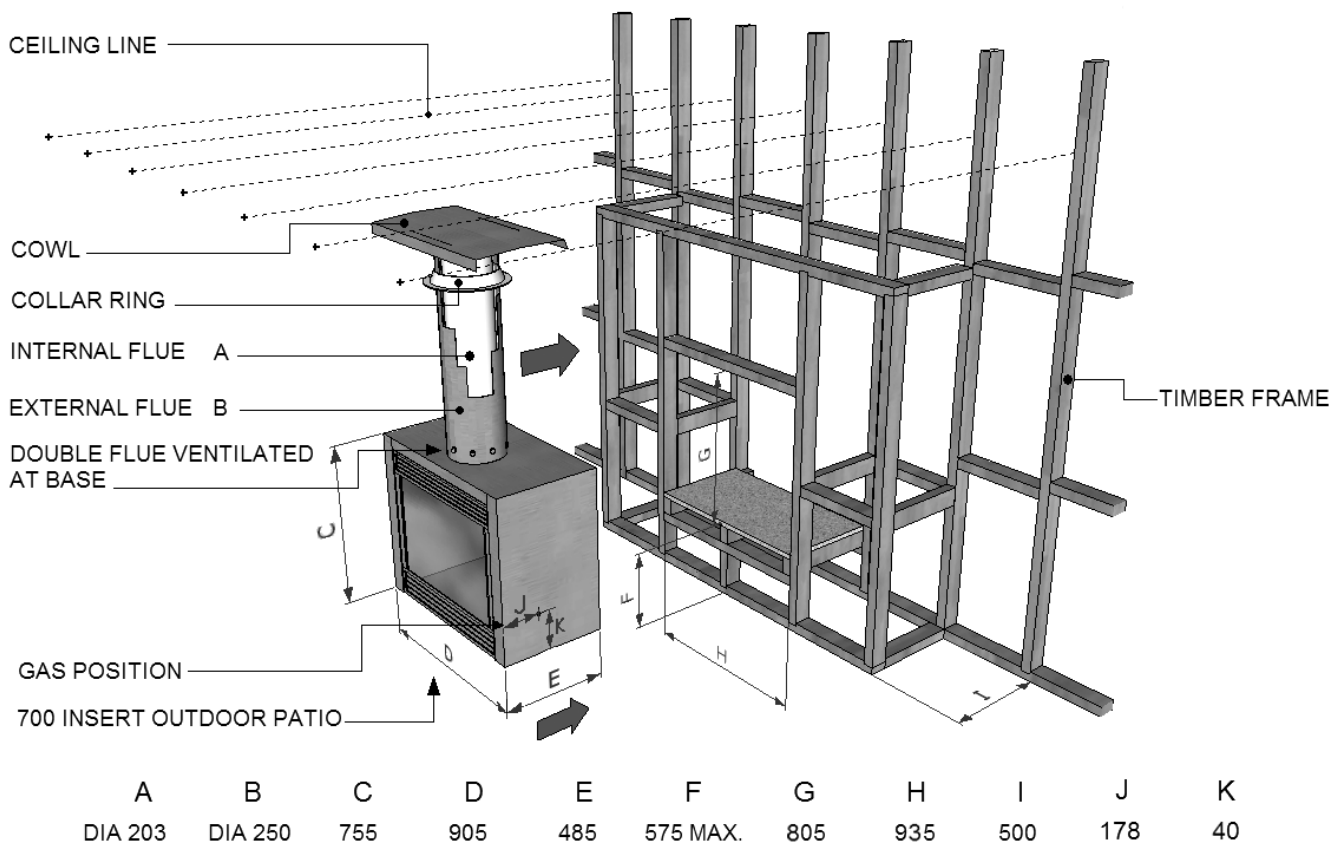

NOTE: BASED ON 2.4 M CEILING HEIGHT

Installation Instructions for Jetmaster Outback Outdoor Patio Fire

STEP 2 - CLEARANCES TO CEILING AND FRAME DIMENSIONS

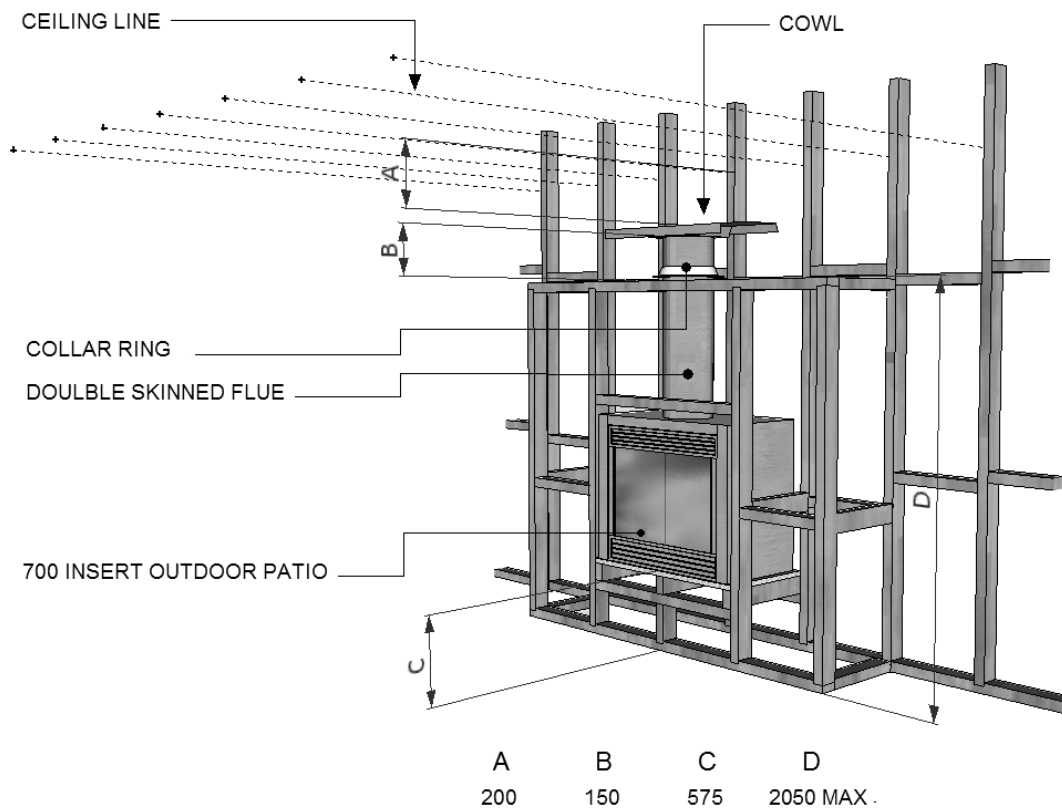

NOTE: BASED ON 2.4 M CEILING HEIGHT

STEP 3 FINAL CLAD INSTALLATION



Installation Instructions for Jetmaster Outback Outdoor Patio Fire

Model Type 700 Freestanding Outdoor Patio Fire

DIMENSIONS AND CEILING CLEARANCES

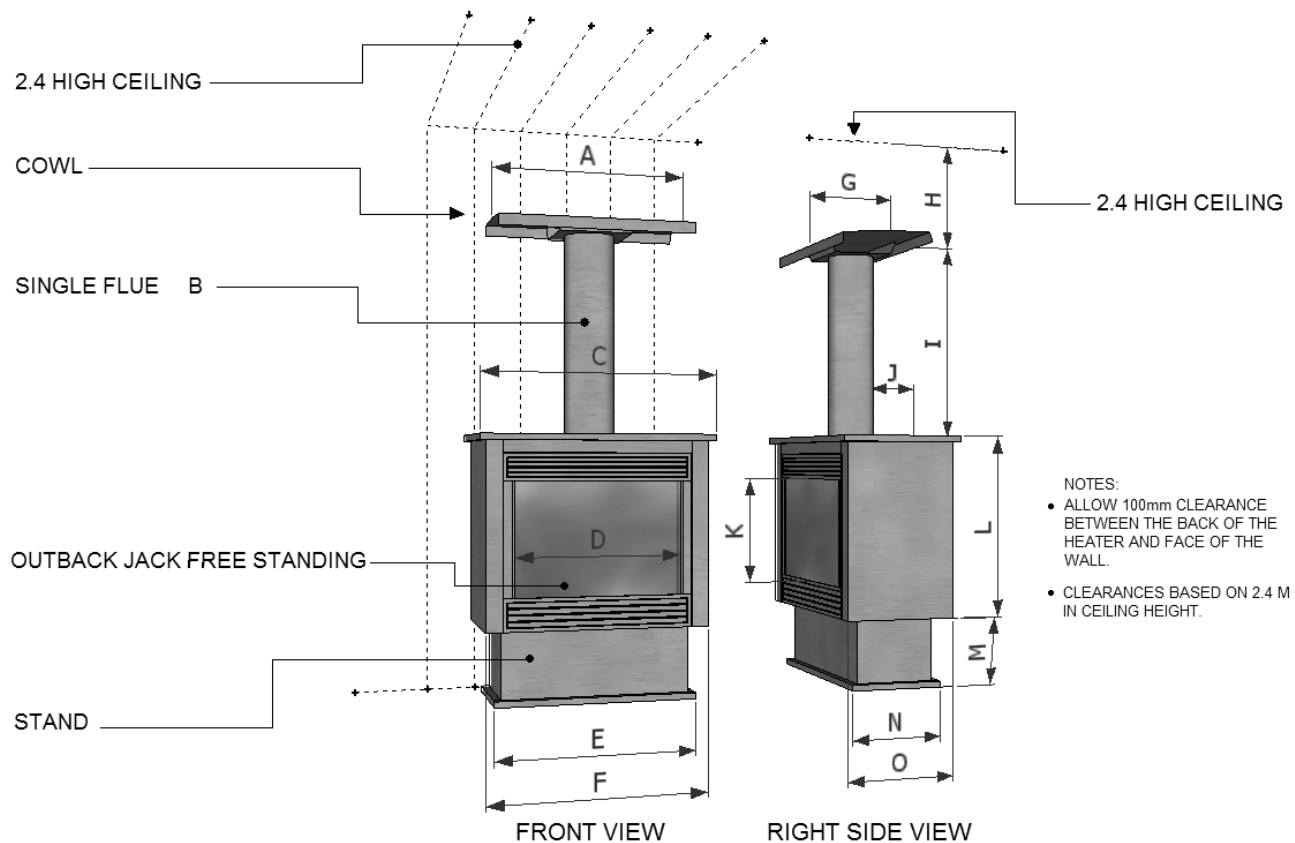

SPECIFICATIONS (MEASUREMENTS IN MILLIMETRES)

A	B	C	D	E	F	G	H	I	J	K	L	M	N	O
800	DIA 203	950	675	820	905	400	200	900	185	460	755	545	435	485

Important

Installation of this appliances should only be carried out by an authorised person in accordance with the manufacturers instructions. All relevant codes and regulations laid down by the gas authorities, uniform building regulations and the requirements of Local Municipal Authorities must be observed.

Appliance installation must comply with AS5601/AG5601 clause 5.12.13.2 and 5.12.13.5.

Data Plate

Refer to data plate for information in respect of gas pressure, consumption and gas type, Natural and LPG (Propane). The data plate is located on the base of unit and is accessed by opening the base louver.

Installation Instructions for Jetmaster Outback Outdoor Patio Fire

Location Requirements

1. The fireplace can only be installed in an outdoor area. Refer to drawings Appendix E. This appliance shall only be used in an above ground open-air situation with natural ventilation, without stagnant areas, where gas leakage and products of combustion are rapidly dispersed by wind and natural convection.

Any enclosure in which the appliance is used shall comply with one of the following:

- An enclosure with walls on all sides, but at least one permanent opening at ground level and no overhead cover.
 - Within a partial enclosure that includes an overhead cover and no more than two walls.
 - Within a partial enclosure that includes an overhead cover and more than two walls the following shall apply:
 - *at least 25% of the total wall area is completely open, and
 - *at least 30% of the remaining wall area is open and unrestricted.
- In the case of balconies, at least 20% of the total wall area shall be and remain open and unrestricted.

2. The deflecting cowl on the top of the flue terminal must maintain a minimum of 200mm below a patio ceiling. The flue diameter is 200mm and is supplied with a fixed cowl. Only used fix cowl supplied by the manufacturer.

3. The firebox is fitted with a permanent glass guard and mesh screen which is affixed to the firebox. This cannot be removed. Code AS2286 (Space heating appliances – secondary guards) requires a dress guard to be affixed to the appliance or fireplace.

4. The built in models need to maintain a minimum of 100mm clearance to a combustible floor. Note clearance dimensions on drawings

5. The fireplace is provided with a flue and terminal as separate components. These components need to be assembled together and attached to the spigot of the firebox.

6. The connection on the burner is ½ inch B.S.P connection and is situated on the right hand side of the firebox. The position is 178mm from front and 130mm from the base. See drawing.

Appendix E

DIAGRAMMATICAL REPRESENTATIONS OF OUT DOOR AREAS - INFORMATIVE

The following figures are diagrammatical representations of outdoor areas as described in the definition Clause 1.2.49. Rectangular areas have been used in these figures - the same principles apply to any other shaped area.

FIGURE E1 - OUTDOOR AREA - EXAMPLE 1

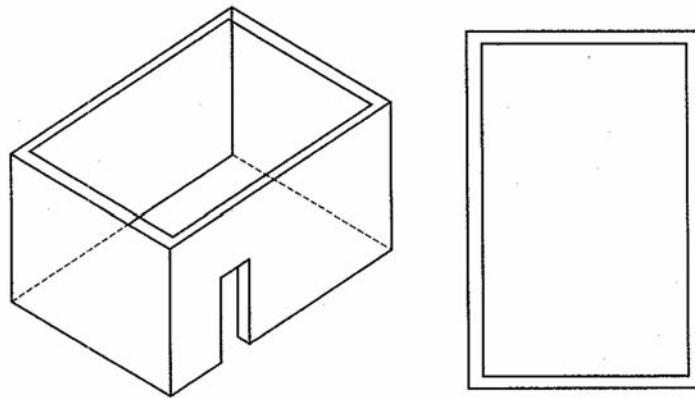
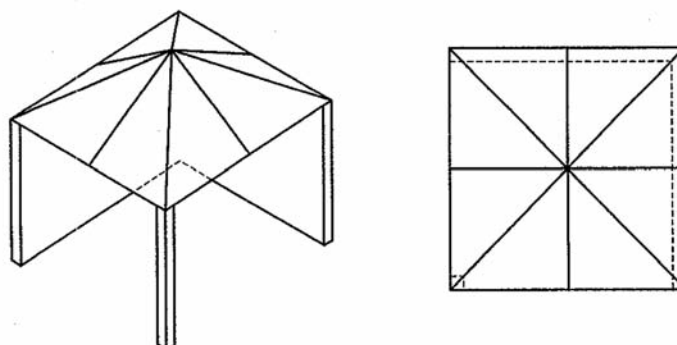

FIGURE E2 - OUTDOOR AREA - EXAMPLE 2



Installation Instructions for Jetmaster Outback Outdoor Patio Fire

Appendix E CONTINUED

FIGURE E3 - OUTDOOR AREA - EXAMPLE 3

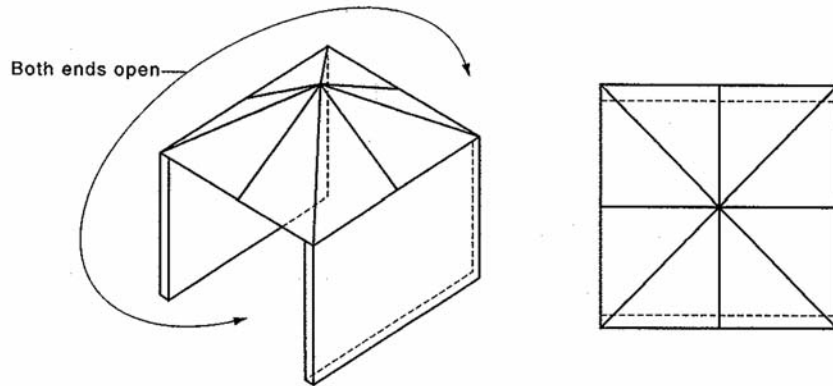

FIGURE E4 - OUTDOOR AREA - EXAMPLE 4

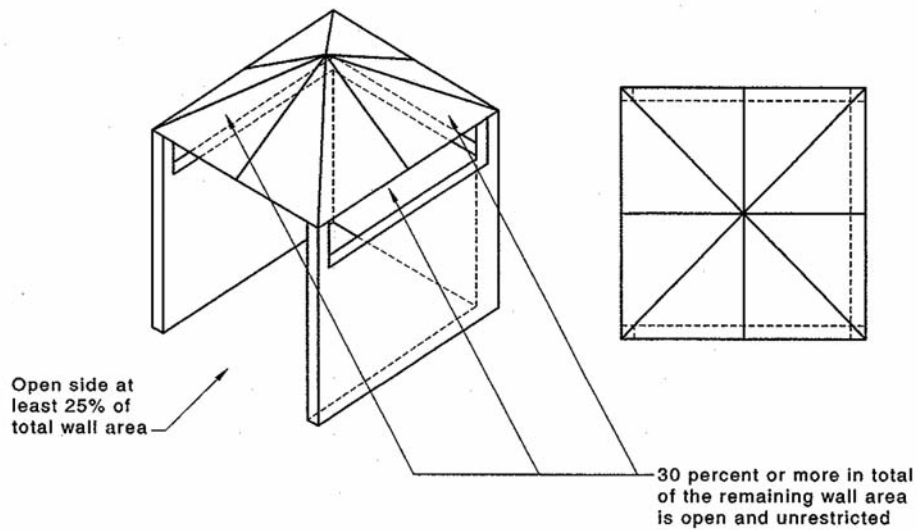
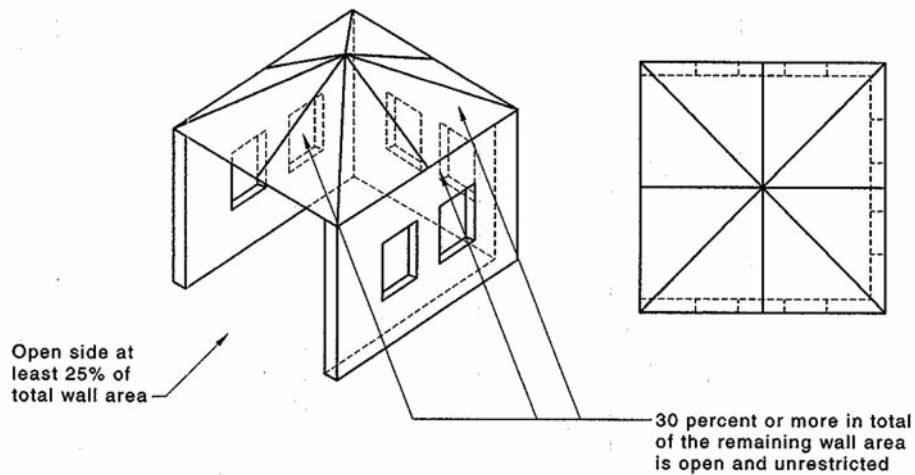
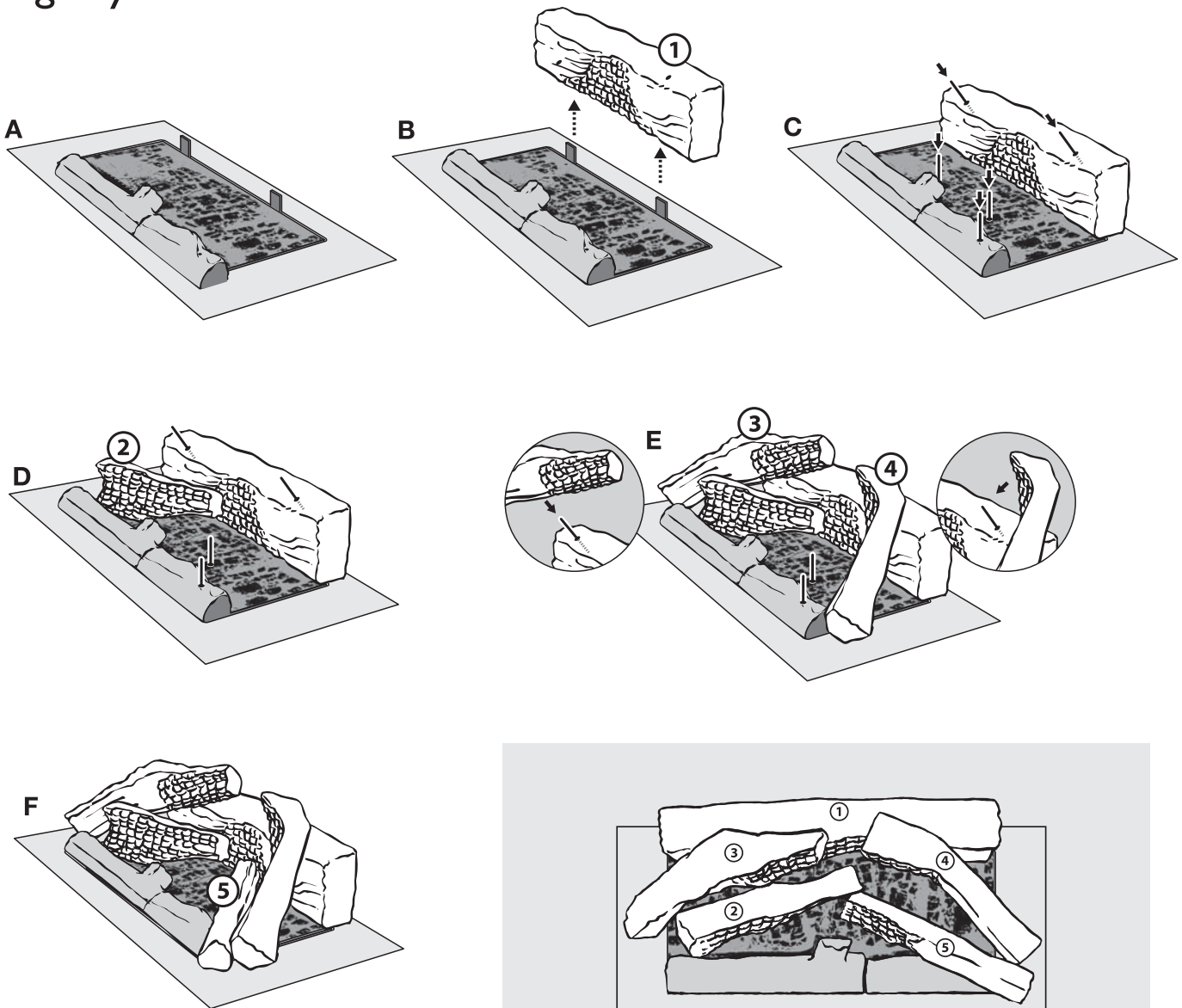

FIGURE E5 - OUTDOOR AREA - EXAMPLE 5



Installation Instructions for Jetmaster Outback Outdoor Patio Fire

Log Layout



POSITIONING OF ALL LOGS

- It is important to follow the log recommended positioning.
- Use pins provided and locate logs as per drawings included.
- Not doing so can adversely effect the operation of the appliance.
- This diagram shows the recommended log positions, when viewed from above.

LOGS

Only use logs supplied by the manufacturer as other logs may effect combustion performance.

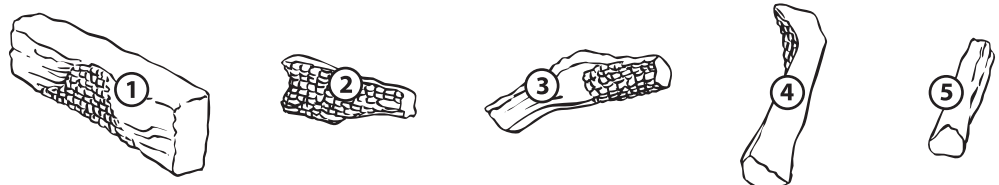

Installation Instructions for Jetmaster Outback Outdoor Patio Fire

Installation: Fitting the Gas Grate

1. Check unit is suitable for intended gas supply.
2. The position of the gas control and inlet is on the right hand side and is 3/8" B.S.P. female connection for L.P.G. A 1/2" regulator is supplied when fitting to natural gas.
3. Cut and debur both ends of pipe. Fit the end to the gas supply point and turn on for approximately 5 seconds to clear the pipe of any dirt or grit. Fit the other end to the gas unit.
4. The regulator is included on the S.I.T. control on the unit.
5. Turn on the gas and check all connections for leaks using soapy water or approved method. Fix any leaks.
6. Possible carbon deposition may occur on the appliance incorporating live fuel effect.

Adjusting Pressure, Pilot and Low Fire

1. All settings are set to operate at appropriate pressures (see data plate). Test point is located on gas valve.
2. Check low fire if adjusted correctly.
3. The pressure can be measured on the gas valve and the regulator adjusted to the appropriate pressure (see data plate affixed to side of the appliance.)

Lighting Instructions

PILOT FLAME IGNITION

Locate control knob on right hand side of valve. Depress and turn control knob (FIG 1) to the ★ PILOT position (FIG 4). Depress the control button and ignite with piezo igniter (FIG 2) whilst keeping control knob firmly depressed for 20 seconds. Check that pilot stays lit. If it goes out repeat ignition procedure.

MAIN BURNER IGNITION

Depress and turn control knob anti-clockwise from ★ PILOT position to the ON position (FIG 5). The burner will not ignite if the rocker switch is depressed in the OFF position (FIG 3). To light main burner press rocker switch to ON position (FIG 3).

TO TURN MAIN BURNER OFF WITH PILOT REMAINING BURNING

Depress rocker switch to OFF position. (FIG 3)

Main burner can also be turned off by the use of control knob. This is done by turning control knob clockwise to ★ PILOT position (FIG 8). Control knob will need to be turned back to ON position (FIG 5) to light main burner.

TO TURN MAIN BURNER OFF OR ON WITH OPTIONAL WALL SWITCH

Pilot must be burning.

Control knob is in the ON position. (FIG 5)

Rocker switch is in the OFF position. (FIG 3)

Wall switch can now be activated.

Important! Wall switch can only be activated if rocker switch is in off position.

TO TURN PILOT AND MAIN BURNER OFF

Depress and turn control knob clockwise from ON position (FIG 5) or ★ PILOT position (FIG 4) to the OFF position (FIG 6).

TO TURN MAIN BURNER HIGHER OR LOWER

Turn high / low flame knob to obtain high or low fire (FIG 7).

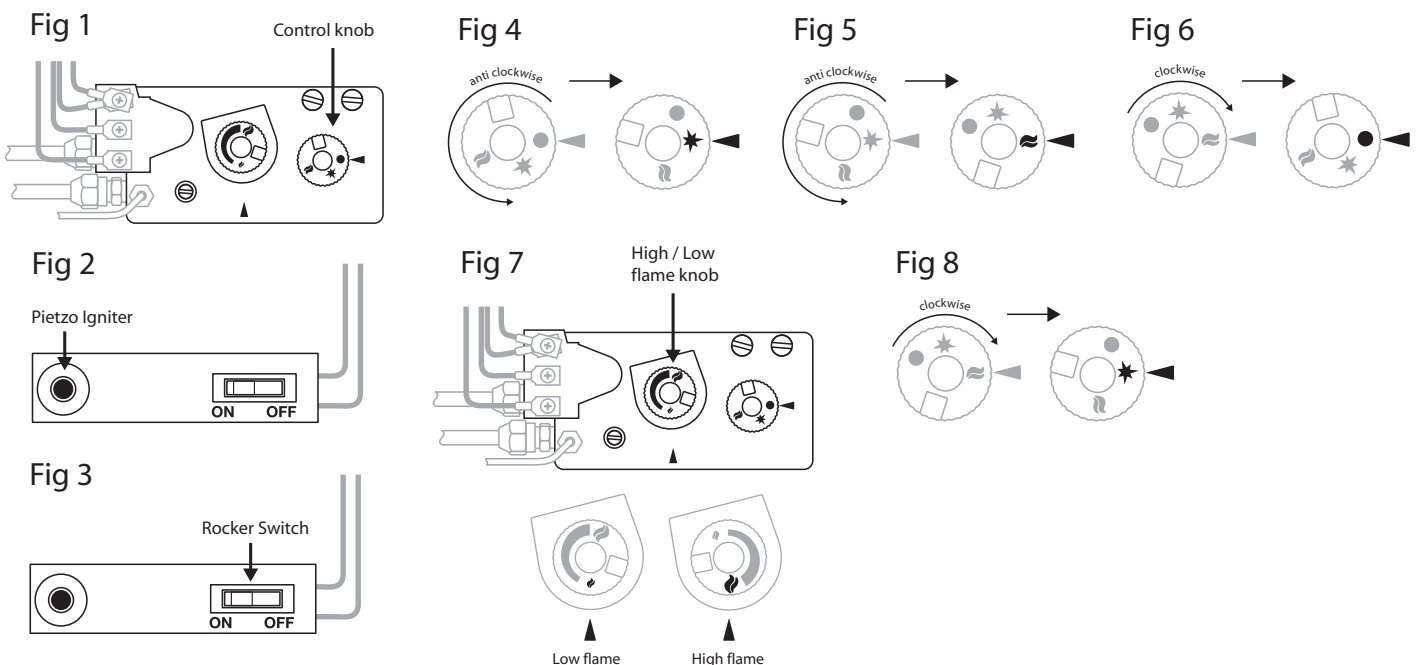

E: sales@jetmaster.com.au W: www.jetmaster.com.au