



OUTDOOR RANGE



ENJOY THE GREAT OUTDOORS

If you love outdoor dining and entertaining then a gas or wood Jetmaster fireplace is the perfect addition to any alfresco area. The fireplace can also be used as a barbecue helping you enjoy your outdoor living year round.





PATIO HORIZON ISLAND

The Patio horizon Island is a stunning feature for any outdoor area. Its Rectangular crystal fire burners are made from high quality 304 stainless steel and includes tempered glass, with 4 different styles and colors to choose from and 1 drift wood log set option. It also comes with a contemporary lightweight concrete top.

The steel base can either be used as its own feature or you have the option to clad with any weather proof product.

FEATURES

- Weather proof 304 Stainless steel burner
- Natural or LPG gas
- Weather proof cement top
- Glass safety screen
- Outdoor use only
- 4 glass media options
- 1 driftwood log set option

TABLE TOP COLOURS



WHITE
CEMENT



GREY SAND
CEMENT



GRANITE

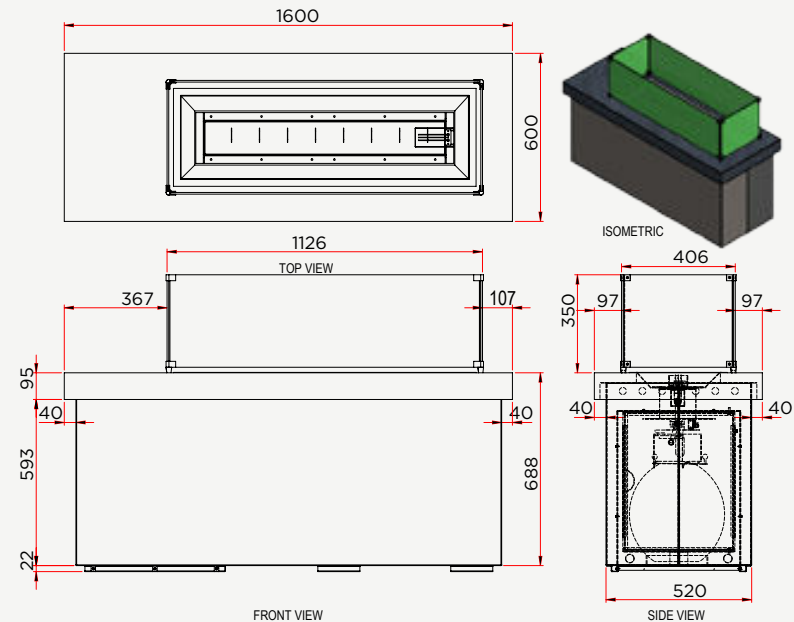



PATIO HORIZON ONYX

The Patio Horizon Onyx will be the center piece of you outdoor entertainment area, with its architectural design fully spun laser cut steel top and base and the amazing round 304 S/S fully welded burner that gives a spectacular flame and breathtaking radiant heat.

Choose from a range of media options to create the look that suits you.

FEATURES

- Weather proof 304 Stainless steel burner
- Natural or LPG gas
- Fully spun contemporary steel top and base
- Glass safety screen
- Outdoor use only
- 4 glass media options
- 1 driftwood log set option

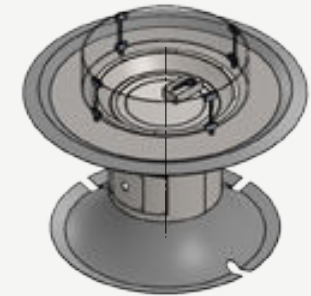
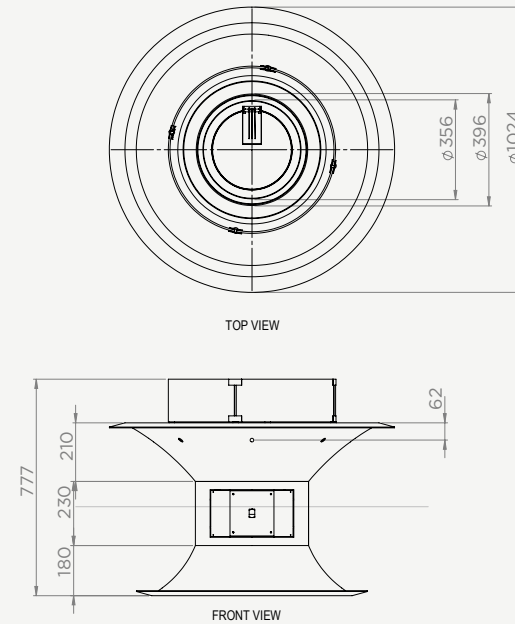

ISOMETRIC

MEDIA OPTIONS FOR HORIZON ISLAND, ONYX AND PANORAMIC



WHITE
LOGSET



GLASS
BEADS



GLASS
DIAMOND



3D
PELLET



TEMPERED
GLASS



GLASS
ICECUBE

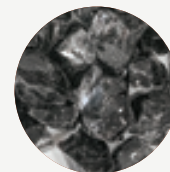

GLASS
ICECUBE

JETMASTER OPEN WOOD OUTDOOR

WOOD BURNING OPTIONAL LOG PANS

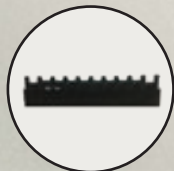

Standard logpan
with picket front



Optional clean face
log pan



Log pan with
optional alfresco
cook top



Optional Outdoor
Screen



CRYSTAL FIRE BURNERS

CUSTOM GAS FIRE PITS

Crystal Fire Burners are made from high quality stainless steel and include tempered glass gems and ignition controls. All standard burners are Australian Gas Approved for safety and quality. They work our line of fire pit tables or can be purchased separately for custom-built fire pits and projects.

Crystal Fire™ Burners run for up to 8 plus hours using 9kg propane tank or can be hooked up to a natural gas line. With just the push of a button, a beautiful clean-burning fire appears atop a bed of tempered glass fire gems.

FEATURES

- Available for Natural Gas and LPG
- 1 year warranty or ignition
- Limited Lifetime Warranty on stainless steel
- Electronic battery operated ignition, or 240 Volt
- Can be purchased individually to be used for custom-built projects
- Glass guard to enhance flame
- Includes: LP hose and regulator, metal flex hose, ball valve, push button sparker system
- Can be installed in open weather areas

20 Crystal Fire Burner	CF-20-LP-DIY	152mm	534mm	4.1kg	63

12x42" Crystal Fire Burner	CF-1242-DIY	118mm	345mm	1086mm	5.5kg	63



CF-20_LP-DI



CF-1242-DIY



PATIO HORIZON PANORAMIC

The Patio Horizon Outdoor gas fire will add an amazing feature to your outdoor space. No flue is necessary so it's easy to install, and with the flick of a switch, you can create a warm ambient setting.

Extend your outdoor entertainment season by enjoying the radiant heat and ambiance created on those cooler Autumn and Spring months

The Panoramic comes standard with porcelain liners this gives a mesmerizing reflection of flame on all three sides enhancing the already impressive flame.

FEATURES

- Natural and LPG gas
- Child safety screen (optional)
- Electronic Ignition Battery or 240 Volt
- Stainless seamless welded burner.
- Porcelain Lined
- Wall switch
- No flue required
- Outdoor use only
- 4 glass media options
- 1 driftwood option

A	B	C	D	E	F	G	H
1190	1227	513	441	230	111	402	495

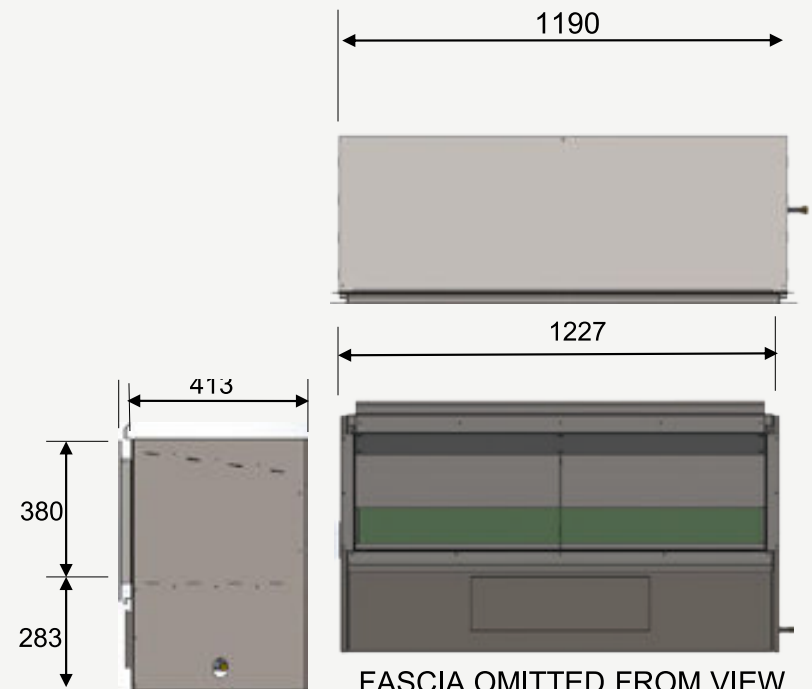

FASCIA OMITTED FROM VIEW

OPTIONAL S/S OR BLACK TRIM

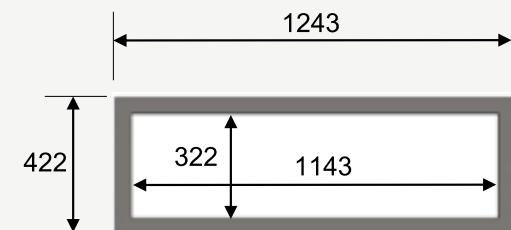



CONTRACTOR

The Contractor range of built in BBQ's will add a new dimension to your entertainment area around which friends and family can gather.

Usable as an outdoor fire aswell as a BBQ, the timeless design will enhance your patio and easily blend with your outdoor entertainment living area.

INCLUDES



NICKEL
PLATED GRILL



CHARCOAL
STARTER
TRAY



CAST IRON
STEWING
POT HOOK

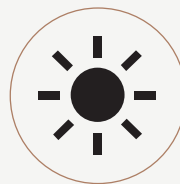

OPTIONAL
LIGHT FITTING



SLIDING DOOR



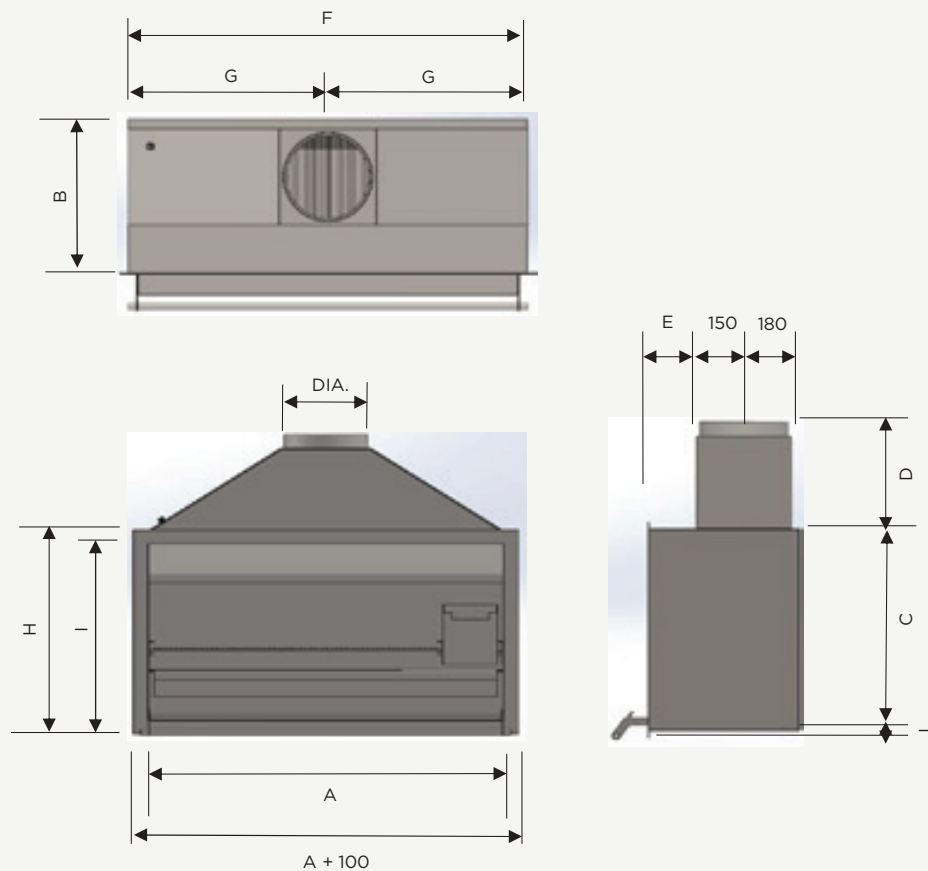

Pictured: Jetmaster built in BBQ & outdoor fire with closed door

FLUE SIZE

MODEL	A	B	C	D	E	F	G	H	I	J	DIA
1000	1000	475	710	240	148	1045	522.5	750	700	23	254
1200	1200	475	710	325	148	1248	622.5	776	776	25	279.4



NOTES

Reliability | Innovation | Service | Quality

For the entire Jetmaster range, visit your nearest showroom
jetmaster.com.au | 1300 538 627

NSW - 55 Marrickville Road Marrickville 2204

QLD - 13 French Ave Brendale 4500

S.A - 40 Maple Ave Forestville 5035

W.A - 277 Lord Street Perth 6000

VIC - www.jetmaster.com.au